



Letterkenny University Hospital Rebuild Update

Presentation to

Board of Saolta University Health Care Group



**Seán Murphy
11th May 2016**

Overview

- **What happened**
- **Extent of Damage**
- **Major Rebuild Programme – Progress to Date**
- **Major Rebuild Programme – Future Projects**
- **Culvert**





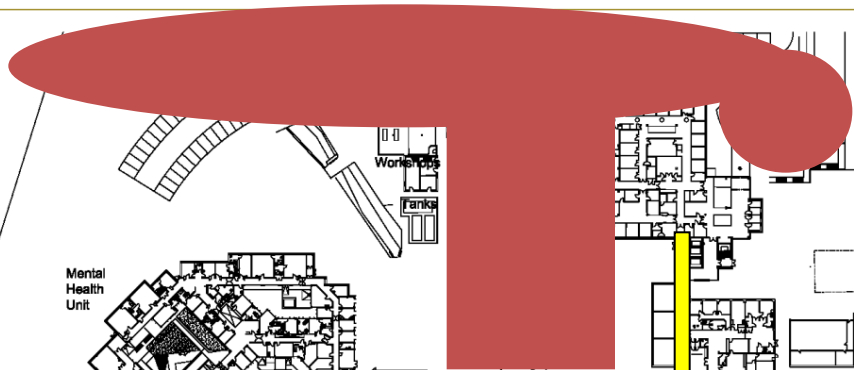

17:45hrs

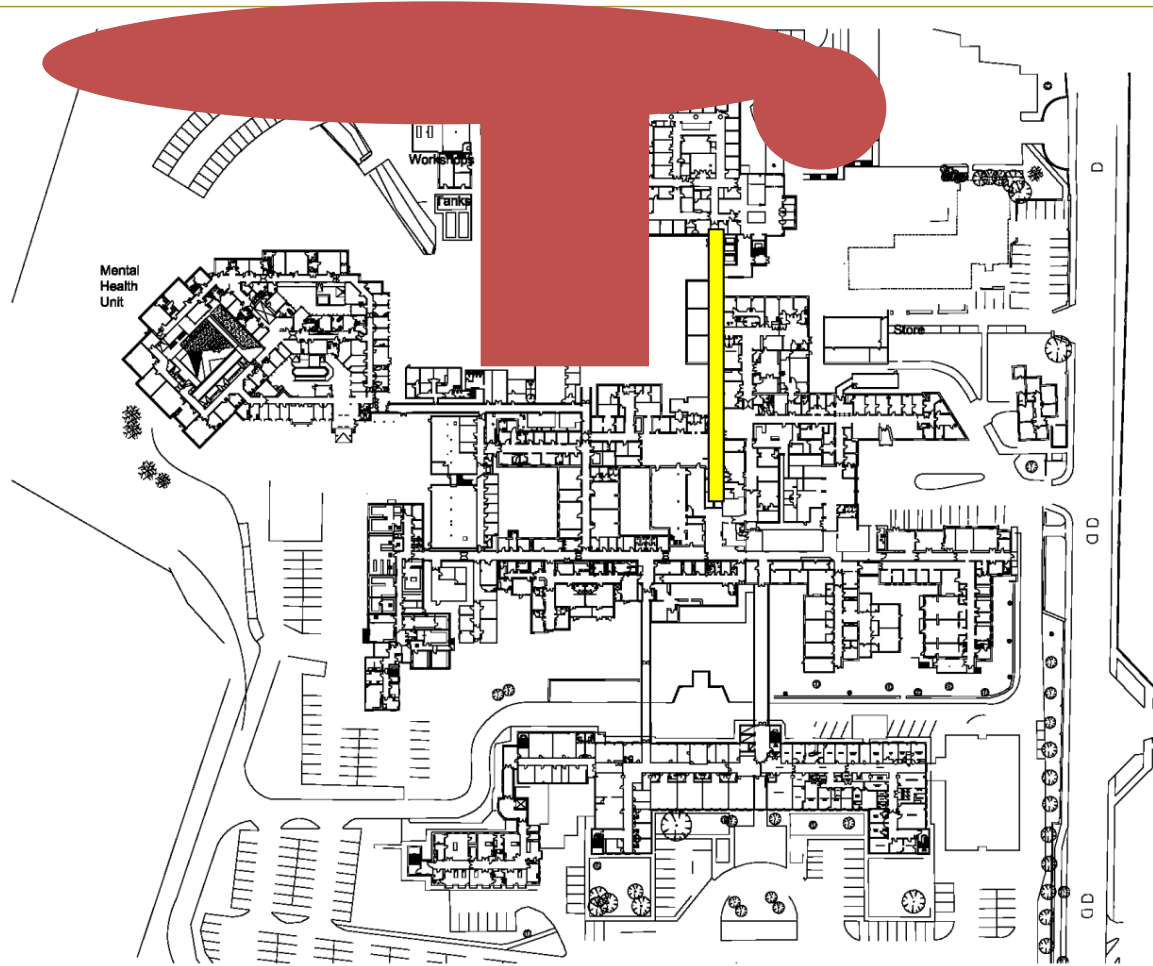

- NOTES
1. Copyright reserved to Adam Leadley Architects.
 2. Work to be carried out in accordance with the drawings.
 3. The contractor responsible for drawing all work to be carried out in accordance with the drawings and shall make all arrangements for the removal of any materials.
 4. Where appropriate, for details of structure, materials or finishes, refer to the contract documents.
 5. Proprietor forms and be held in strict accordance with the contract documents, unless otherwise indicated.
 6. Sites of temporary works shall be checked with the contractor.
 7. The contractor shall be responsible for the coordination of existing services and utilities.

No.	Date	Comments

No.	Date	Comments

Project: SURVEY OF EXISTING GYNECOLOGY WARD
 AT LETTERKENNY GENERAL HOSPITAL,
 LETTERKENNY, Co DUBLIN

Drawing No: LEVEL B - BUILDING SURVEY

Drawing No: H025-18-01 Rev: 01 Issue: DE
 Scale: 1:500 Date: 11-09-13
 Drawn: AI
 Checked: AI

Adam Leadley Architects

Chartered Architects | Surveyors | Project Managers

Office: 100 North Wall, High Road, Letterkenny, Co. Donegal
 Tel: +353 (0)71 911 1111 Fax: +353 (0)71 911 1112
 Email: info@adamleadley.com



18:00hrs

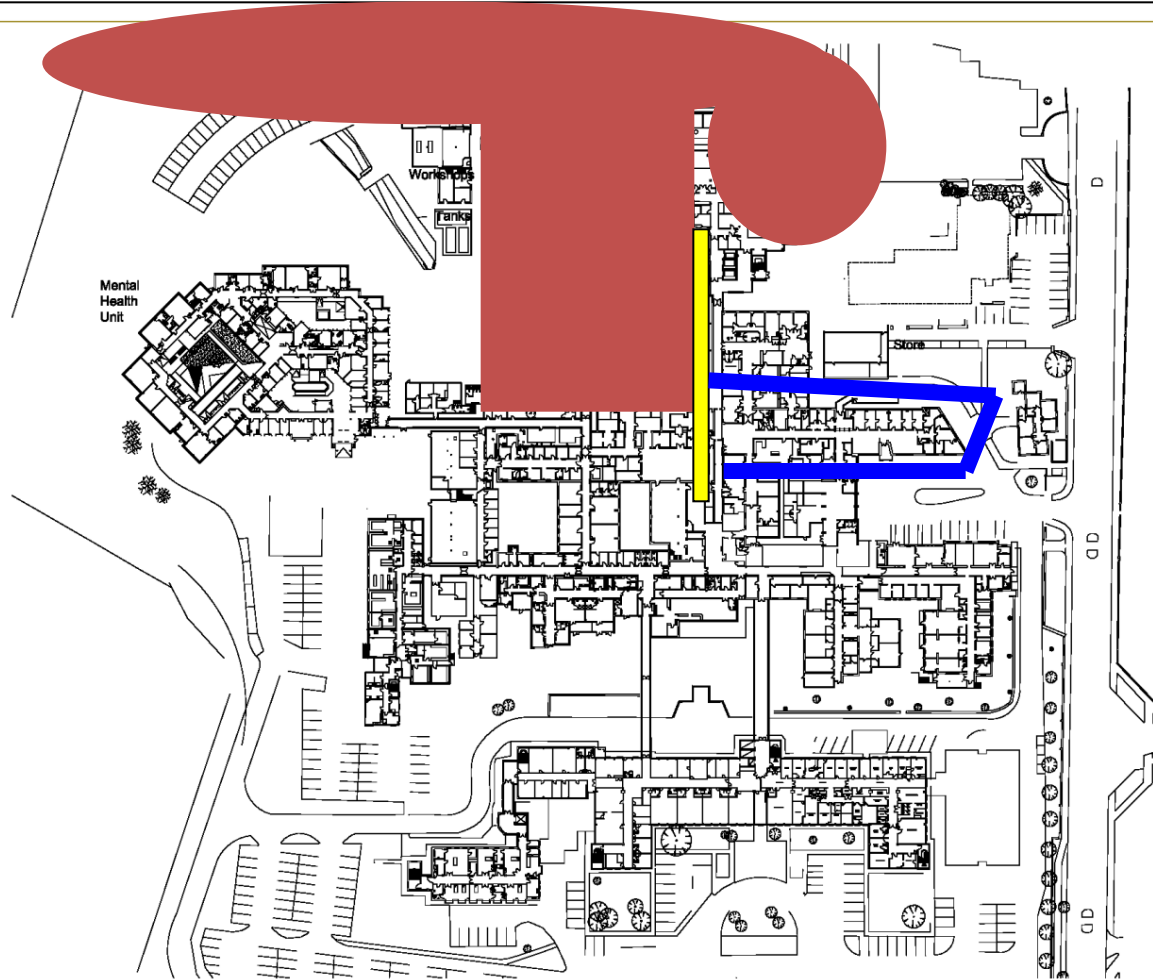

- NOTES**
1. Copyright reserved to Adam Leadley Architects.
 2. View to be opened immediately after the start of the drawing.
 3. The contractor responsible for checking all levels and dimensions on site, and that all dimensions to be as shown.
 4. Where appropriate, for safety of structure, mechanical or electrical work, the contractor shall ensure that the structure is supported and braced in accordance with the relevant standards and codes of practice.
 5. All work shall be carried out in accordance with the relevant standards and codes of practice.
 6. All work shall be carried out in accordance with the relevant standards and codes of practice.
 7. The contractor shall be responsible for the coordination of all other trades and services.

Rev.	Date	Comments	Rev.	Date	Comments

Project SURVEY OF EXISTING GYNCOLOGY WARD
AT LETTERKENNY GENERAL HOSPITAL,
LETTERKENNY, Co DUBLIN

Drawing No. LEVEL B - BUILDING SURVEY

Client Ref. H025-18-01 **Rev.** 01 **Drawn By** AL **Checked** AL

Scale 1:500 **Date** 11-09-13 **Printed** AL

Adam Leadley Architects

Chartered Architects | Surveyors | Project Managers

Units 1 & 2, Ballymore Park, High Road, Letterkenny, Co. Donegal
 Tel: 071 922 2222 Fax: 071 922 2223 www.adamleadley.com

18:05hrs

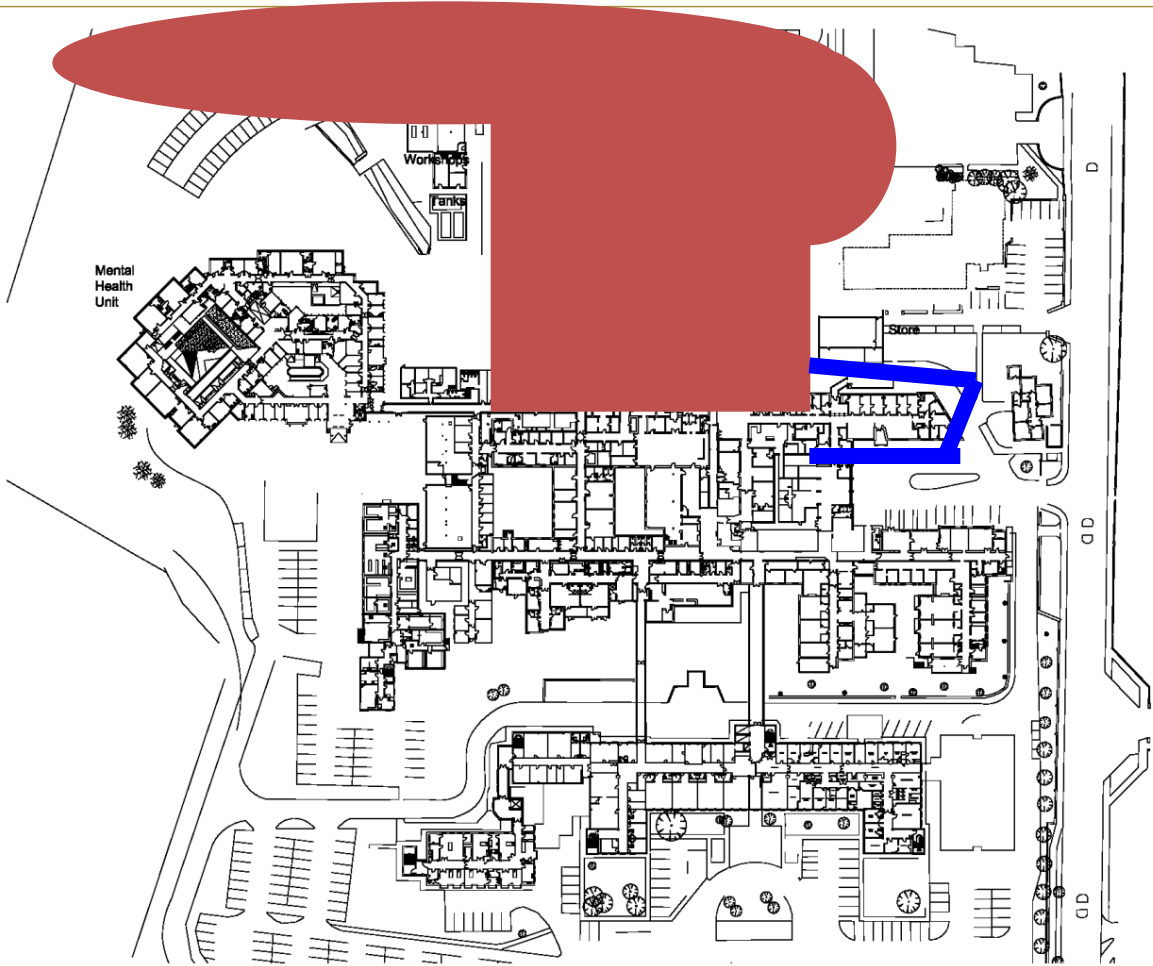

- NOTES:**
1. Copyright reserved to Adam Leadley Architects.
 2. Work to be completed immediately. Do not scale the drawings.
 3. The contractor is responsible for obtaining all necessary planning, building, and other relevant permissions for the works.
 4. Where appropriate, for details of structure, construction or services details, see construction documents.
 5. Proprietor to ensure that the work is carried out in accordance with the relevant building regulations, where applicable.
 6. Sites of significance to be identified and checked with the relevant authorities.
 7. The contractor shall be responsible for the coordination of existing services and utilities.

Rev.	Date	Comments	Rev.	Date	Comments

Project: SURVEY OF EXISTING GYNECOLOGY WARD
AT LETTERKENNY GENERAL HOSPITAL,
LETTERKENNY, Co DUBLIN

Drawing No.: LEVEL B - BUILDING SURVEY

Drawing No.: H025-18-01 **Rev.:** 01 **Issue:** DK **Checked:** AL

Scale: 1:500 **Date:** 11-09-18 **Drawn:** AT

Adam Leadley Architects

Chartered Architects [Registered] Project Managers

Office: 5, Southmain, High Road, Letterkenny, Co. Donegal
Tel: 02876 511111 Fax: 02876 511111
Email: info@adamleadley.com



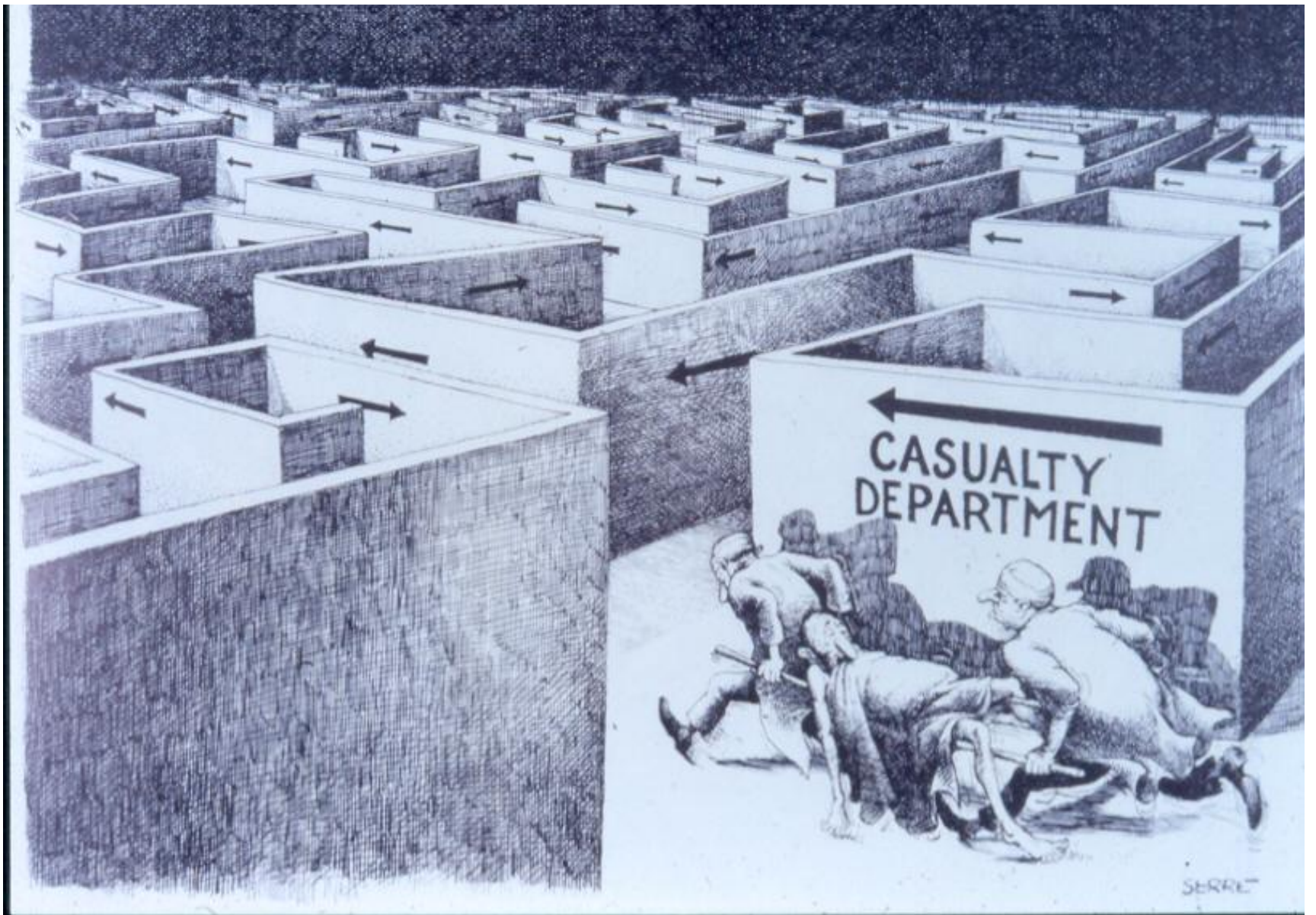

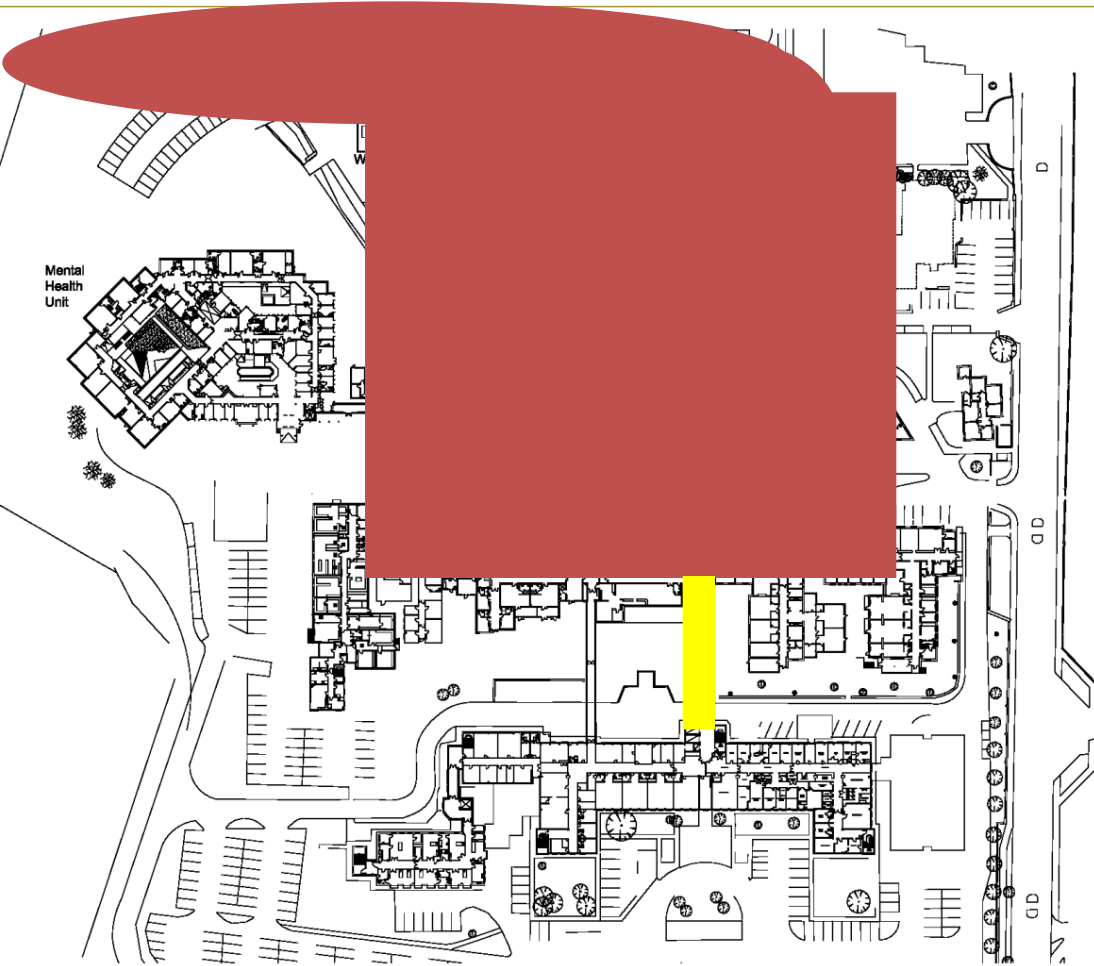

18:20hrs

- NOTES:**
1. Copyright reserved to Adam Leadley Architects.
 2. Work to be carried out as early as possible to avoid the main building.
 3. The contractor is responsible for obtaining all necessary consents, permits and all other approvals for the works.
 4. Where appropriate, for details of structure, construction or materials, refer to the contract documents.
 5. Proprietor to ensure that the work is carried out in accordance with the contract documents, where necessary to be checked.
 6. All of the contractor's work and the finished work to be checked with the manufacturer.
 7. The contractor shall be responsible for the coordination of all other work on the site.

No.	Date	Comments	No.	Date	Comments

Project: SURVEY OF EXISTING GYNECOLOGY WARD AT LETTERKENNY GENERAL HOSPITAL, LETTERKENNY, Co DUBLIN

Client: LEVEL 8 - BUILDING SURVEY

Drawn by: H025-18-01 **Rev.:** **Drawn by:** DK **Checked:** AL

Scale: 1:500 **Date:** 11-09-18 **Rev.:** AL

Adam Leadley Architects

Checked: Architects | Approved: Project Managers

Office: 2nd Floor, 100, High Street, Letterkenny, Co. Donegal
 Tel: 071 922 1111
 Email: info@adamleadley.com



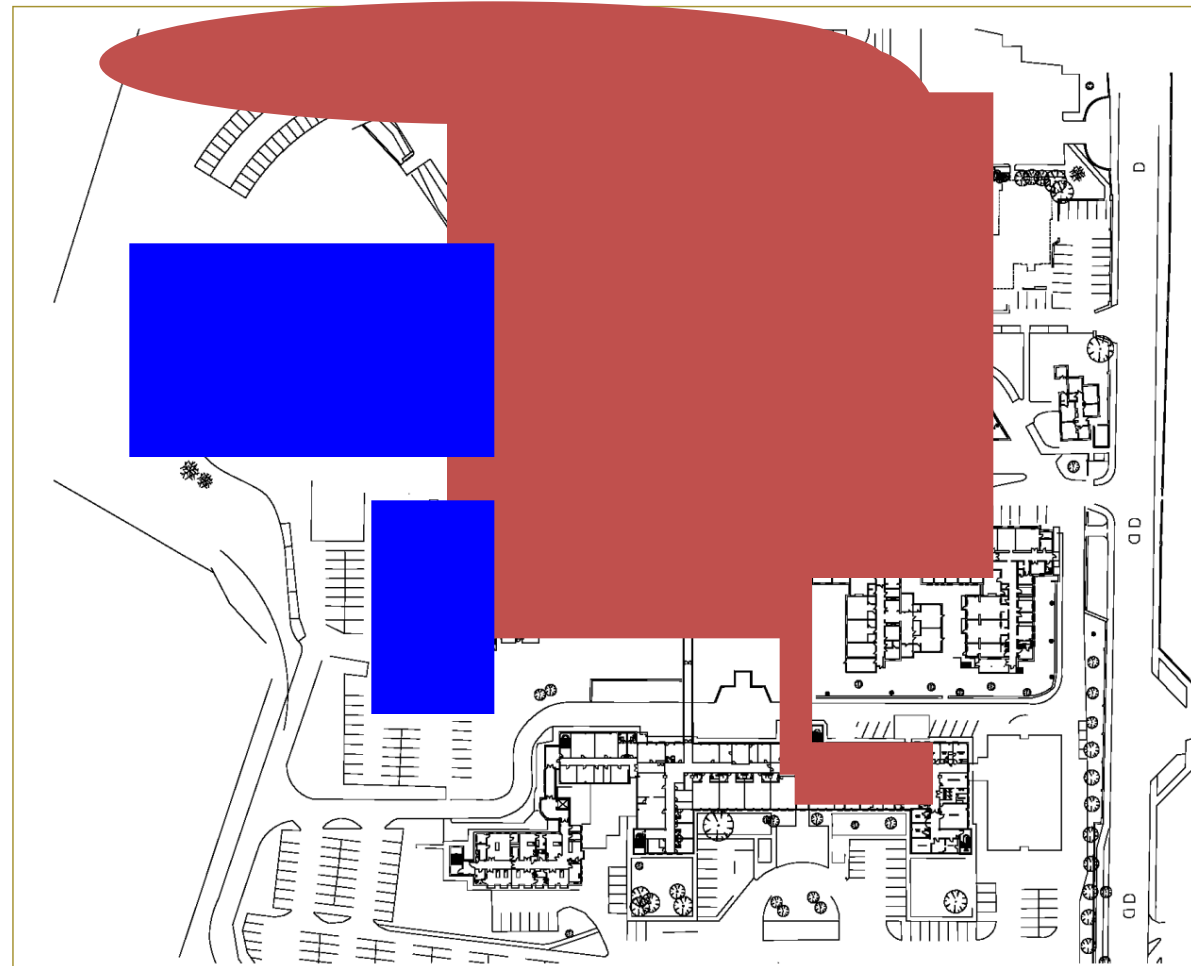

18:35hrs

- NOTES:**
1. Copyright reserved to Adam Leadley Architects.
 2. Work to be carried out in accordance with the drawings and specifications.
 3. The contractor is responsible for obtaining all necessary consents, licences, and third party consents for the proposed works.
 4. Where appropriate, for details of structure, mechanical or electrical details, see relevant specification drawings.
 5. Proprietor to ensure that all work is carried out in accordance with the drawings and specifications.
 6. All work to be carried out in accordance with the drawings and specifications.
 7. The contractor shall be responsible for the coordination of all works and services.

No.	Date	Comments	No.	Date	Comments

Project SURVEY OF EXISTING GYNECOLOGY WARD AT LETTERKENNY GENERAL HOSPITAL, LETTERKENNY, Co DONEGAL			
Drawing No. LEVEL B - BUILDING SURVEY			
Drawing No. K025-18-01	Rev. 1	Drawn By DK	Checked By AL
Scale 1:500	Date 11-09-18	Plot No. AT	Sheet No. AT

Adam Leadley Architects
 Chartered Architects (Ireland) Project Managers

Office: 40-42, Market Street, Letterkenny, Co. Donegal
 Tel: 028 7333 0000
 Email: info@adamleadley.com



Extent of Damage

- 40% floor space, eliminating over 70% of capacity
- Coronary Care Unit
- Emergency Department
- Radiology Department
- Haemataology Oncology Ward
- Kitchen & Dining Facilities
- Laboratory
- Main Out-Patient Department
- Cardiac Investigations
- Medical Records & Office Accommodation



Emergency Admissions 2012

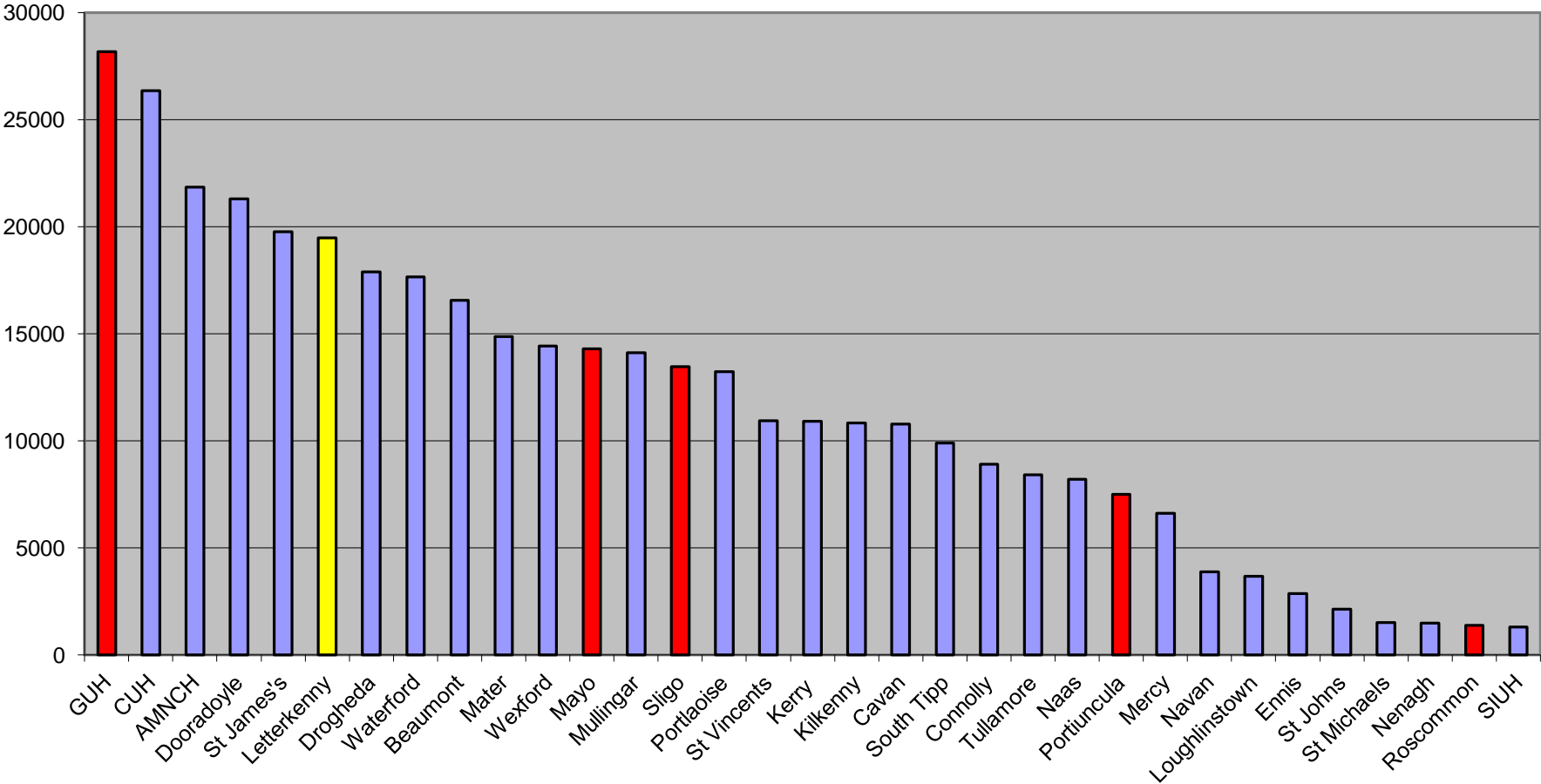

Deprivation map

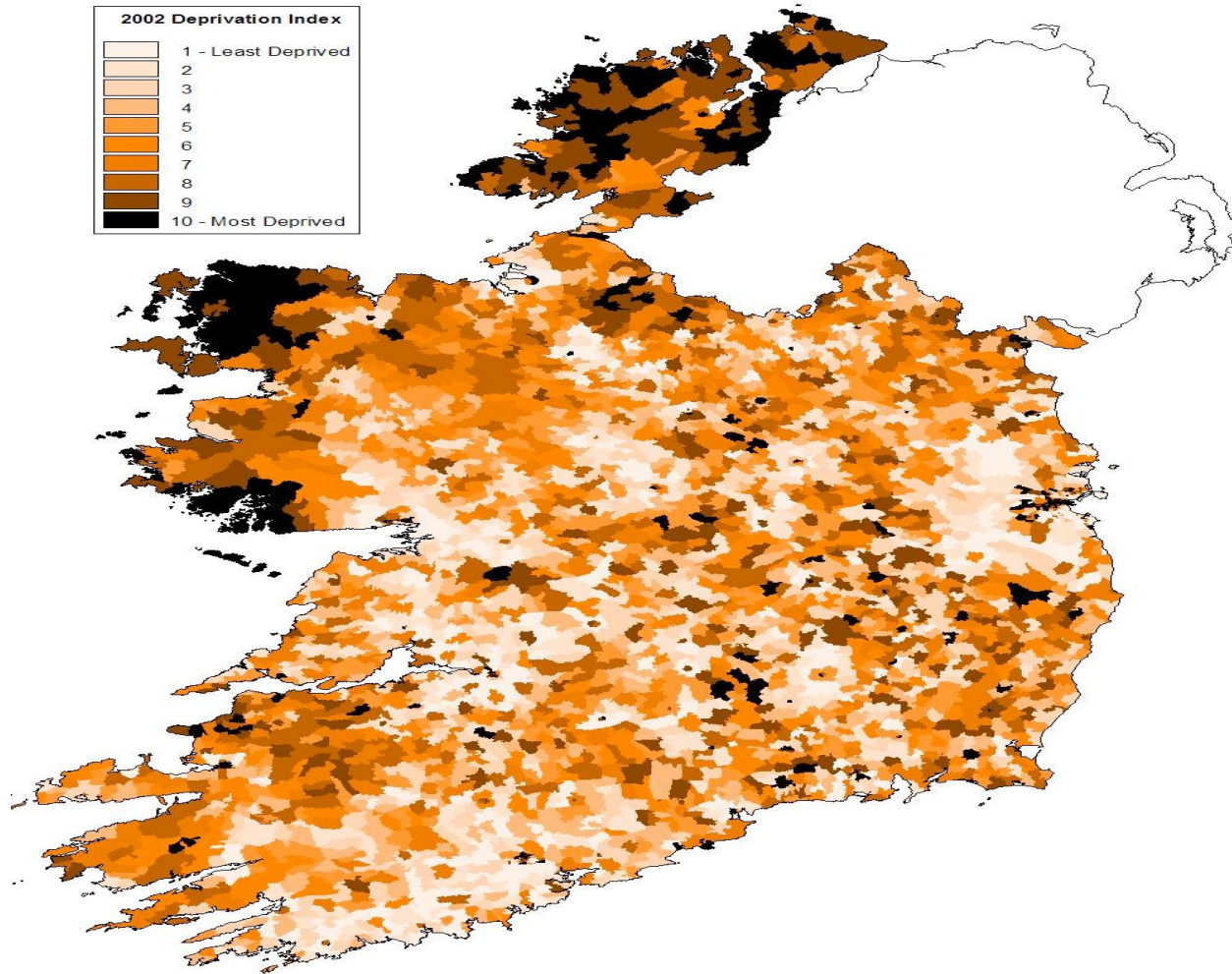

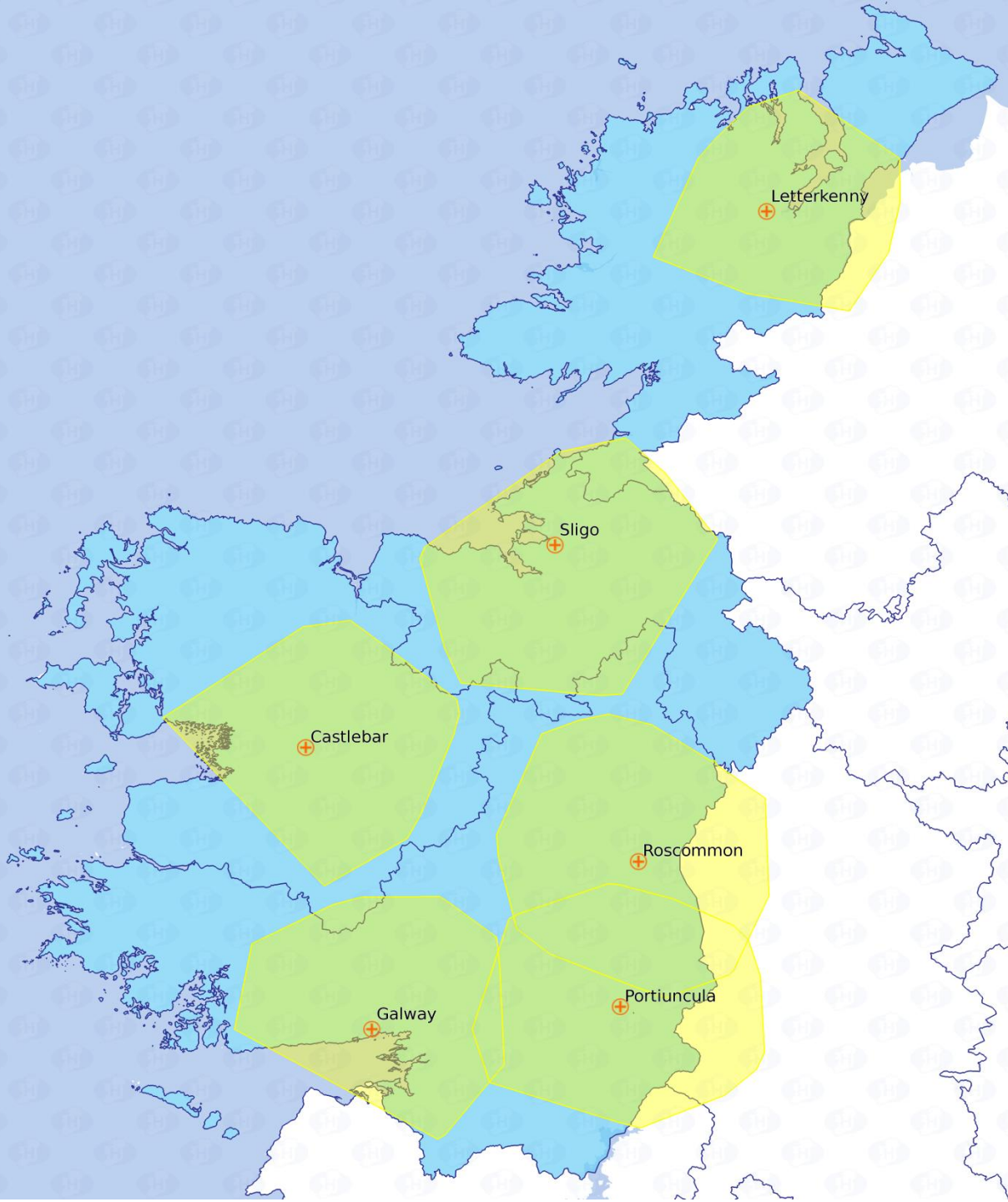

**Hospitals in
Saolta Group
within 30
minute travel
times**

Relocation of Flooded Wards

- Coronary Care Unit (CCU)
 - Patients evacuated to Main Theatre Recovery Area
 - 8 beds in Medical 3 Ward identified as interim relocation area
 - Appropriate monitoring put into Med 3 and telemetry system upgraded
- Haematology & Oncology Ward
 - Patients evacuated to 1980's Building
 - 10 beds in Medical 4 identified as interim relocation area

Reprovision of Radiology

- Relocation of Radiology Department
- X-Ray Printer for Donegal Hospital
- Mobile CT
- Modular Digital Radiology
- Outsource MRI
- Restored PACs/ Storage Area Network (SAN)
- Restoration of Ultrasound Capability





Re-provision of Bed Capacity

By November 2013:

- Reopening of Gynaecology Ward in-patient beds – provided 11 beds.
- Refurbishment of Flood Damaged Gynaecology Ambulatory Care Facilities **(Sept.)**
 - Colposcopy Suite
 - Early Pregnancy Assessment Unit

Gynaecology Ward



Re-provision of ED/Ambulance Support

- Location identified & Plan agreed
- Undertaken in 2 Phases to allow early opening
- Former Medical 3 Ward converted
- Phased re-opening commenced 3 weeks after flood
- New site traffic flows and car parking
- Phase 2 – extension of modular building to provide new waiting room

Sligo/ Altnagelvin

- Ambulance Diversion Protocols
- Diversion to Altnagelvin
- Diversion to Sligo
- Redeployment of Letterkenny Staff
- Twice Daily Teleconferences
- 22nd August – Diversions stood down for Sligo/Altnagelvin



**Alliance[®]
Medical**

Intelligent imaging

**Mobile
CT
Scanner
Unit**

Independent provider
of medical imaging
www.alliancemedical.co.uk







Emergency Dept
Ambulances Only

Emergency Dept
Ambulances
Only

EMERGENCY
AMBULANCE

NCE



Alliance
Medical

Intelligent imaging

AMBULANCE

KEEP CLEAR

AMBULANCE

KEEP CLEAR

Emergency Dept
Entrance



Other Group Support

- Mayo
- GUH
- Donegal County Hospital
- Erne Hospital Enniskillen

Other Agencies

- Army – Finner Camp
- Garda Siochana
- Donegal County Council
- Eurocarparks
- Community Volunteers
- Department of Health
- Local Businesses
- Fire Service
- Aramark
- Alliance Medical



Temporary Medical Records Dept. St. Conal's Campus



Temporary Pharmacy Department St. Conal's Campus



Temporary Hospital Kitchens St. Conal's Campus



Temporary Staff Dining Room



OUT-PATIENT SERVICES

Out-Patient Clinics re-established within 60 hours

- Phased basis
- Geographical Spread
 - NowDoc
 - LUH
 - Donegal Town
- Some capacity constraints – dictated by site

Main Out-Patient Department Interim Facility



Out Patients Department Reception

5
X-Ray

4

Review
Appointment
Letters



Scope of Works

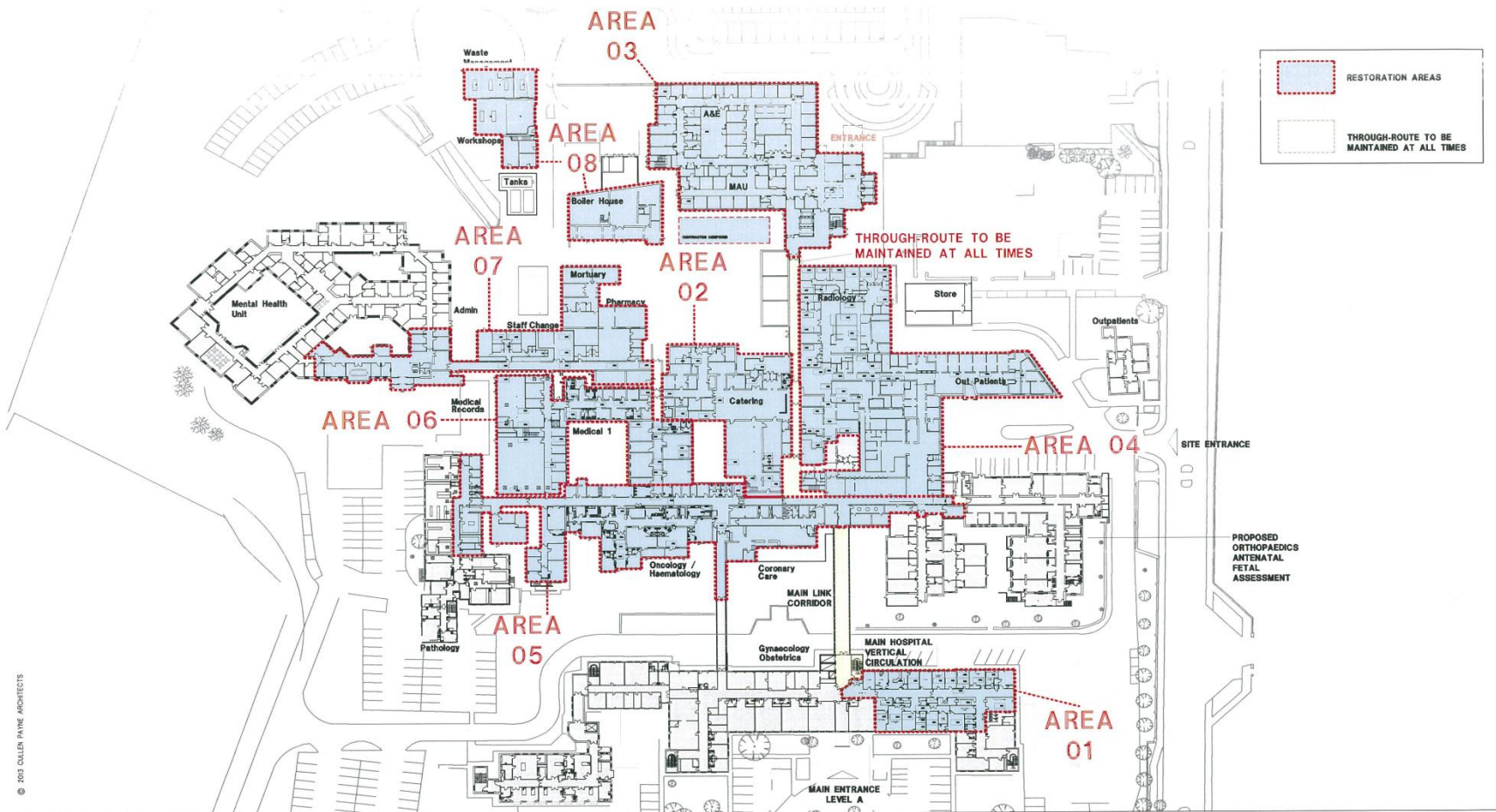

© 2013 COLLEN PAYNE ARCHITECTS



A
B

1321 LGH Restoration Project						Drawing title		
Architect Collen Payne Architects 1000 Perry Street P.O. Box 1000 Perry, VA 22969						IDENTIFICATION OF RESTORATION AREAS LEVEL B		
Drawn	Check	Date	CAD File No.	Job No.	Status	Drawing No.	Revision	
DE	NTS	8.09.2013	1321DD001	1321	DD	001	B	

Scope of Works

- Area 1 Gynaecology / Obstetrics
- Area 2 Kitchens
- Area 3 Emergency Department
- Area 4 Radiology and Outpatients
- Area 5 Coronary Care / Haematology / Oncology / Echo
- Area 6 Medical Records / Medical Wards
- Area 7 Staff Change / Pharmacy Stores / Mortuary / Admin
- Area 8 Boiler House and Underground Ducts

Time Scales



Letterkenny University Hospital Rebuild Projects – 11th May 2016

PROJECT	WORKS START DATE	COMPLETED
Emergency Department/Acute Medical Assessment Unit	November 2013	Re-Opened March 2014
Pharmacy Department	November 2013	March 2014
Pulmonary Laboratory	March 2014	June 2014
Chapels	November 2014	December 2014
Clinical Office/Chaplaincy Room		
Kitchen/Dining Room	October 2014	April 2015
Pathology Laboratory	May 2015	November 2015
Physiotherapy & OT Department		January 2016

PROJECT**WORKS START DATE****COMPLETED**

Emergency Department/Acute Medical
Assessment Unit

November 2013

Re-Opened March 2014



PROJECT

WORKS START DATE

COMPLETED

Pharmacy Department

November 2013

March 2014



PROJECT	WORKS START DATE	COMPLETED
Pulmonary Laboratory	March 2014	June 2014



PROJECT	WORKS START DATE	COMPLETED
Chapels	November 2014	December 2014
Clinical Offices/Quiet Room		



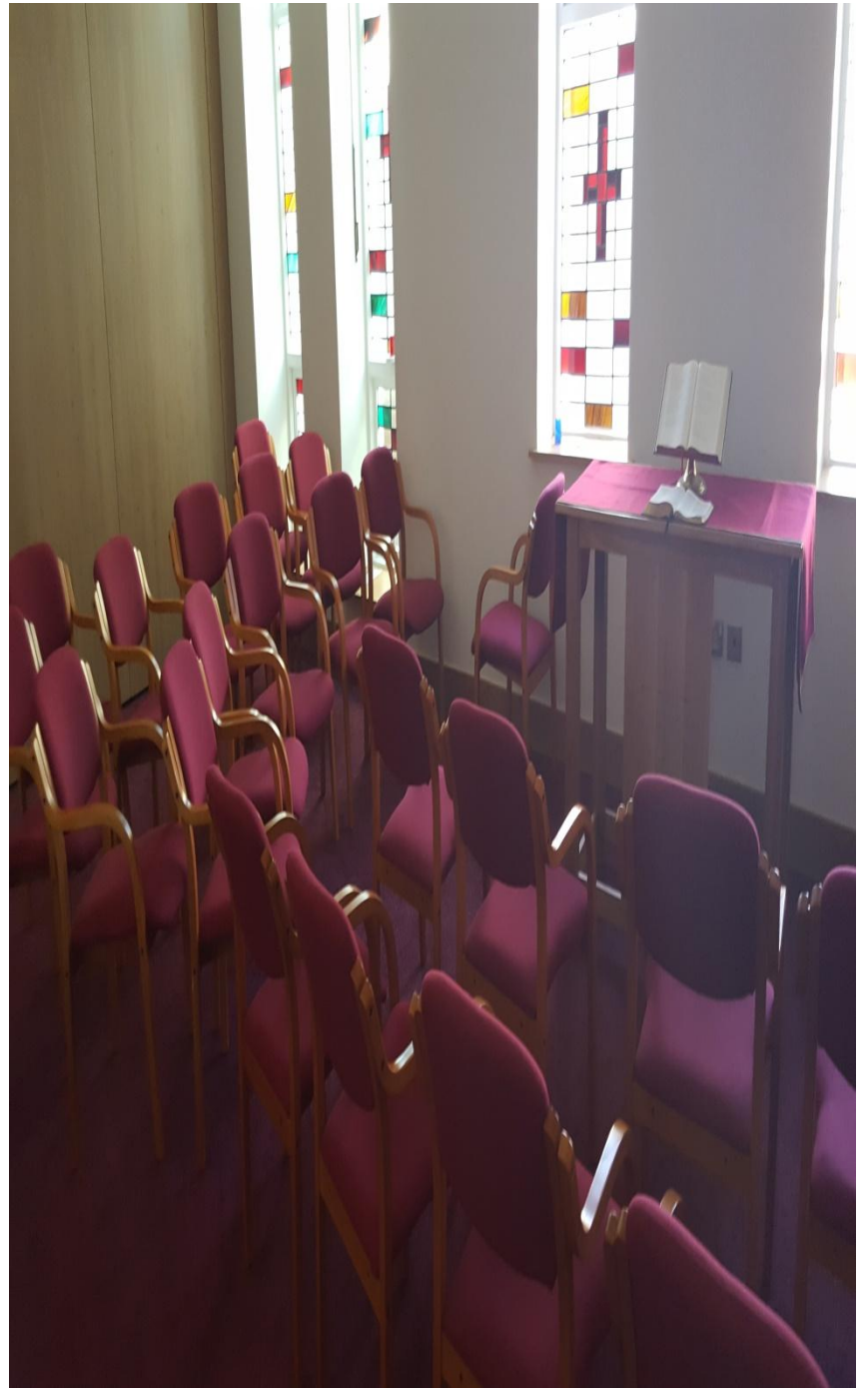

PROJECT

WORKS START DATE

COMPLETED

Kitchen/Dining Room

October 2014

April 2015



PROJECT

Ante-Natal & Gynaecology
Out-Patient Department

WORKS START DATE

May 2015

COMPLETED

June 2015



PROJECT	WORKS START DATE	COMPLETED
Pathology Laboratory	May 2015	November 2015



Ireland's First Fully Integrated Blood Sciences Laboratory



PROJECT**WORKS START DATE****COMPLETED**

Interim Physiotherapy & OT
In-Patient Unit

Mid November 2015

January 2016



PROJECT	WORKS START DATE	WORKS COMPLETION DATE	NEXT STEPS
Medical Records	November 2015	April 2016	Relocate Med.Records June 2016

- Medical Records Department refurbished post-flood – Completed 9th September 2014
- Department adjusted to accommodate temporary Pathology Laboratory – from January 2015 to March 2016
- Works then undertaken to “put right” the facility – Completed end April 2016
- New shelving being delivered May 2016
- Culling of Medical Records initiated April 2016
- Relocation of Medical Records Service scheduled for June 2016

Cardiac Investigations	January 2014	March 2014	
-----------------------------------	---------------------	-------------------	--

- Cardiac Investigations Department refurbished post-flood – Completed 9th September 2014
- Department adjusted to accommodate temporary Pathology Reception – from January 2015 to December 2015.
- Department then used as decant destination for Clinical Skills Laboratory to facilitate opening of 10 additional beds on Medical 5 Ward
 - Medical 5 conversion completed December 2015
 - Additional beds opened January 2016
- Permanent location for Clinical Skills Lab. identified December 2015
- Construction of New Clinical Skill Lab. To be completed June 2016



PROJECT	WORKS START DATE	WORKS COMPLETION DATE	NEXT STEPS
Coronary Care Unit and Haematology & Oncology	May 2016	March / April 2017	Appoint Contractor

- Complete Redesign of Coronary Care Unit to make it fit for 21st Century purpose
- New ward layout to support Patient Observation and Clinical Care Delivery
- New Isolation Room
- New Single Room

- Additional Isolation Rooms in Haem Onc Ward

Letterkenny University Hospital

Future Rebuild Projects as at 11th May 2016

PROJECT	WORKS START DATE	WORKS COMPLETION DATE	NEXT STEPS
Radiology Project	Early 2017	Mid 2018	Complete Detailed Design / Approval to appoint Contractor
Boiler House, Maintenance Buildings & Ducts	End 2016	End 2017	Detailed Design & Approval to procure Contractor
Mortuary, Changing Rooms & Stores	TBC	TBC	Revised submission to be developed within funding constraints
Relocation of Main Physio & OT Dept's to LUH site	TBC	TBC	Radiology to vacate interim accommodation
Outpatient Department	TBC	TBC	Submission in context of LUH Strategic Capital Plan

CULVERT / FLOOD PROTECTION

Work Completed to date

- Survey of stream and culvert
- Assessment of existing culvert
- Identification of proposed storm overflow route
- Installation of additional debris screens
- Automated Water Level Monitoring & CCTV at each screen
- Overflow culvert & catchment basin constructed
- River bank stabilisation completed

SPRACKBURN PRE-WORKS



SPRACKBURN POST-WORKS



Remote Monitoring



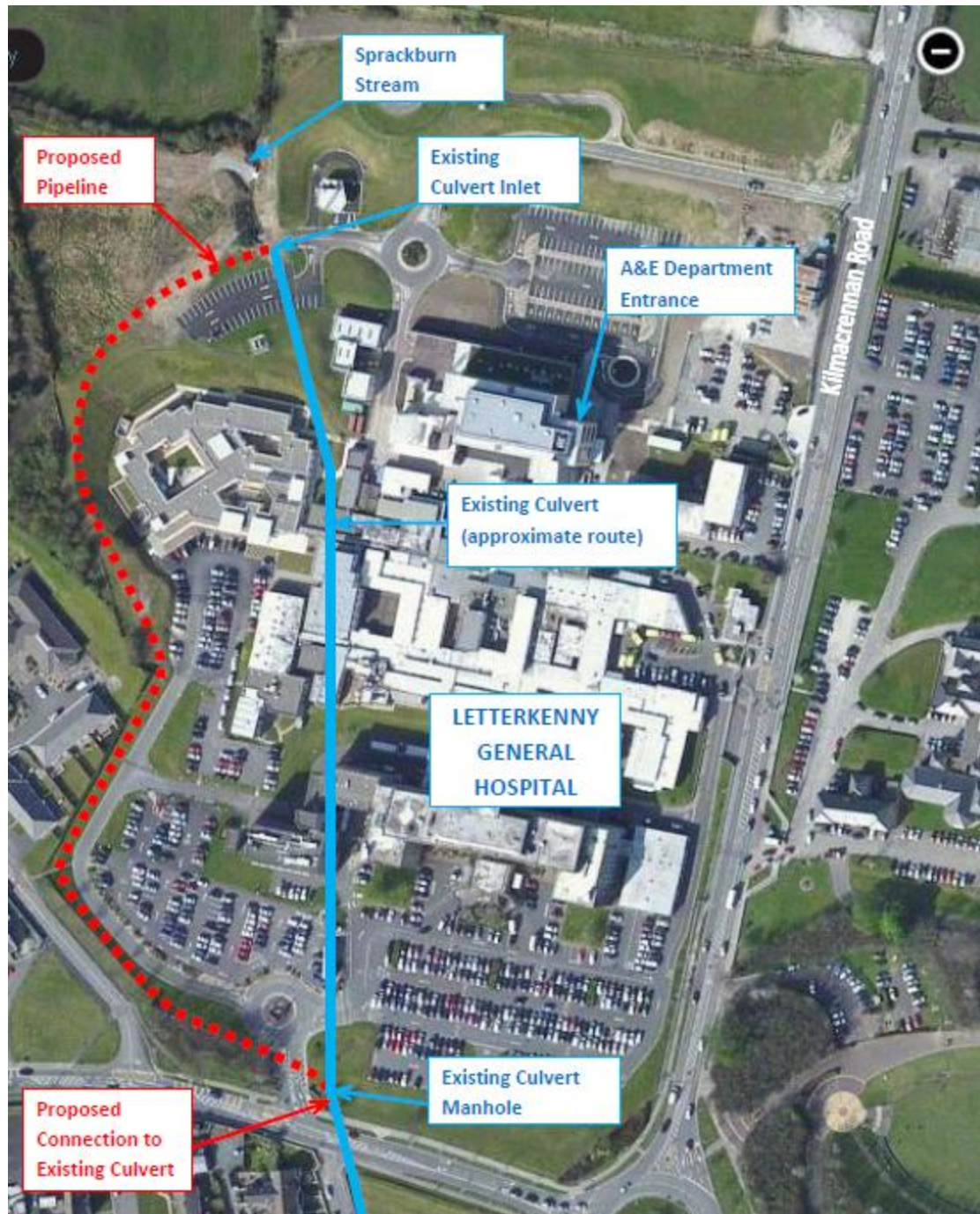

Tertiary Protection Measures



Thank You

